

SSTTT2 - STAINLESS STEEL CABLE TIE TENSIONER

Specifications:

- Length: 178 X 140 X 29mm
- Weight: 554g
- Stainless steel tie: Thickness 0.25mm, Width 4.5 ~ 7.9mm
- Material: Main body made of Aluminium, SK5 blade, Ratchet made of stainless steel, Other metalparts are made of carbon steel
- Life cycle (in normal use): Tool body around 20,000 times, Blade/Ratchet set around 5,000 times

Tension strength:

Strength Level	Width	Tension strength (Kgf)
1	4.5 mm	31.5
2		47.0
3	7.9mm	58.7
4		65.0

For reference only

CABAC replacement part information:

PART NO.	DESCRIPTION
Y-SSTTT2-34	PART- REPLACEMENT RATCHET SET FOR SSTTT2
Y-SSTTT2	JAW S/STEEL TIE TENSION TOOL REPAIR KIT
Y-SSTTT2-BLADE	S/STEEL TIE TENSION TOOL- SPARE BLADE
Y-SSTTT2-13	SPARE PART- ADJUST PLATE FOR SSTTT2
Y-SSTTT2-5	SPARE PART- BLADE SEAT FOR SSTTT2
Y-SSTTT2-40	SPARE PART- M4 NUT FOR SSTTT2
Y-SSTTT2-22	SPARE PART- M4X29.2 SCREW FOR SSTTT2
SSTTT223	STAINLESS STEEL CABLETIE TENSIONER SPRING

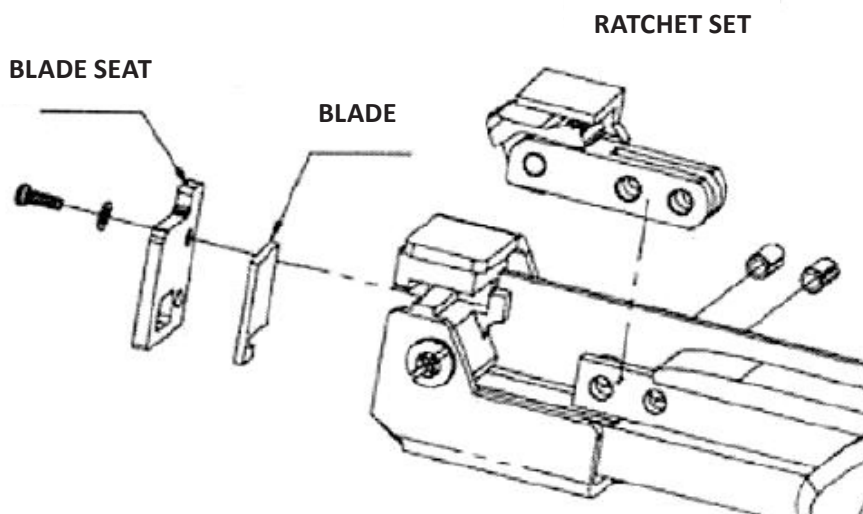

In support of our policy of continuous product improvement we reserve the right to change materials and specifications without notice. Drawings, where shown, may not be to scale. Dimensions are metric and size maybe approximate. Where possible data sheets including MSDS are made available on our website. All products should be installed and used in accordance to manufacturer's instruction provided. Warning: products may be subject of registered designs and patents. Refer to our website for terms and conditions on warranty.

MKT295-1223

Australia Sales: T: 133 122 | E: sales@cabac.com.au | W: cabac.com.au

New Zealand Sales: T: 0800 776 969 | E: sales@cabac.co.nz | W: cabac.co.nz

SSTTT2 - CABLE TIE FASTENING PROCEDURE

1) Loop cable tie around bundle and pull tie by hand.



2) Adjust bundling tension strength.



SSTTT2 - CABLE TIE FASTENING PROCEDURE

3) Place SSTTT2 tensioner by inserting tie into blade & jaw assembly.

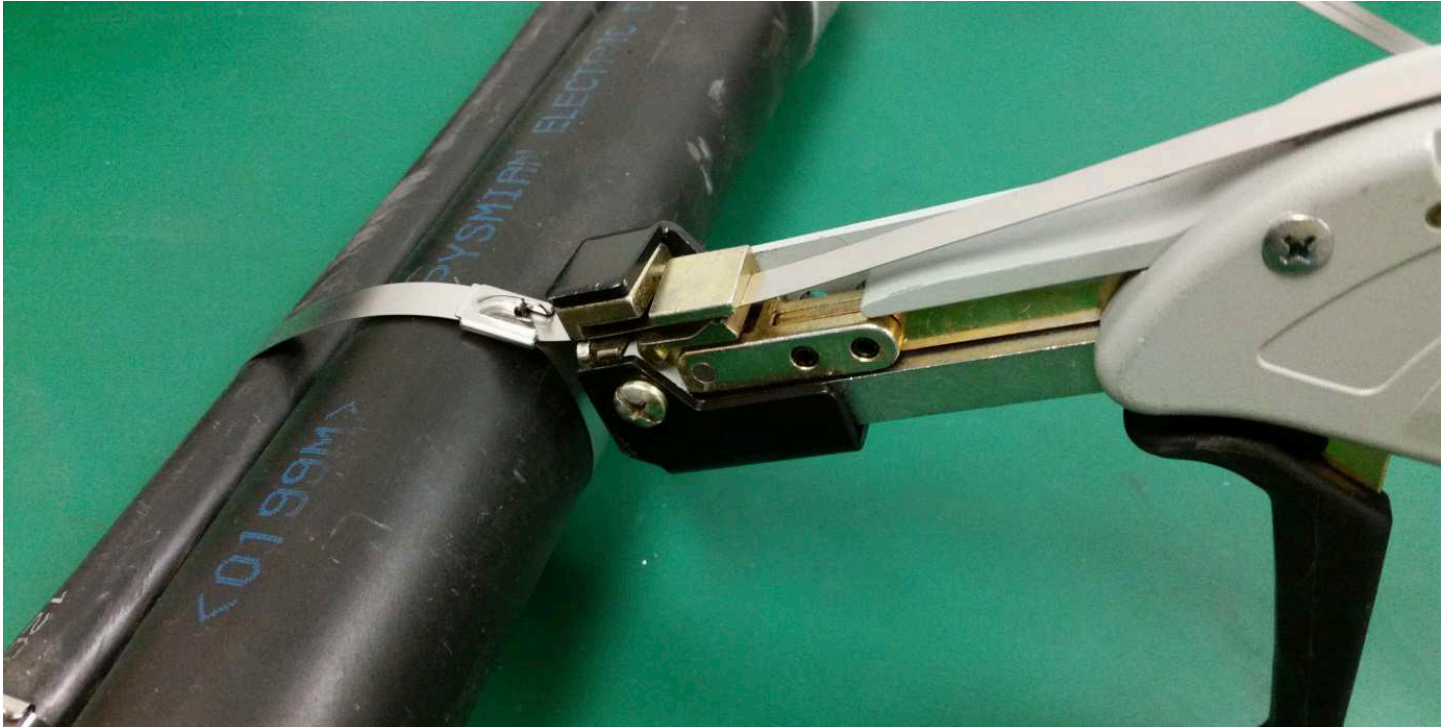

4) Squeeze handle as many times as needed until cut.



SSTTT2 - CABLE TIE FASTENING PROCEDURE

5) Remove cut-off portion from the tool and check cable tie is properly installed.



SSTTT2 - STAINLESS STEEL CABLE TIE LOCKING HEAD POSITION

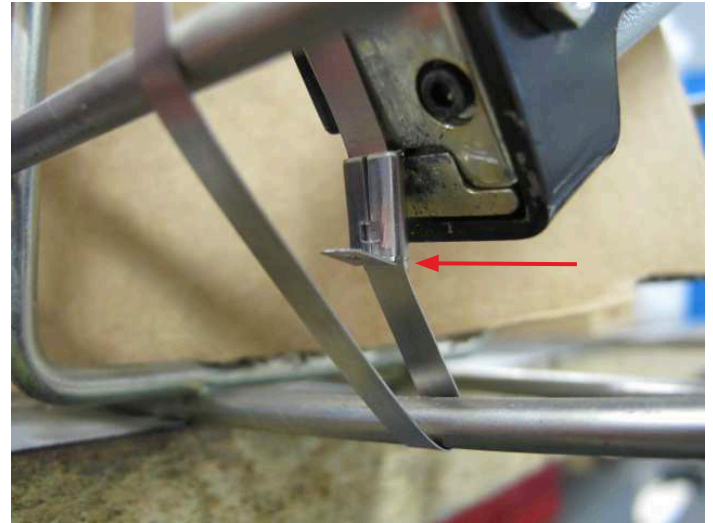
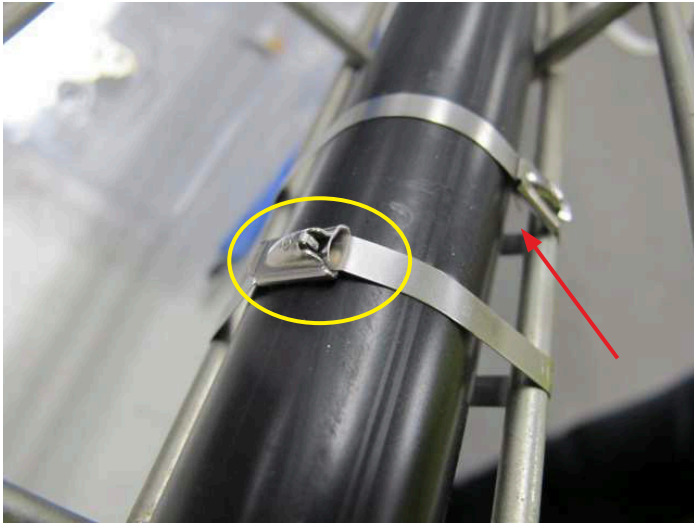

The SS cable tie highlighted in yellow is the recommend way of installing this type of cable tie. The back of the locking head should rest on flat surface to keep it secure. If the back side is hanging it will come loose as shown in the photo (red arrow) while tightening using the cable tie tensioner.

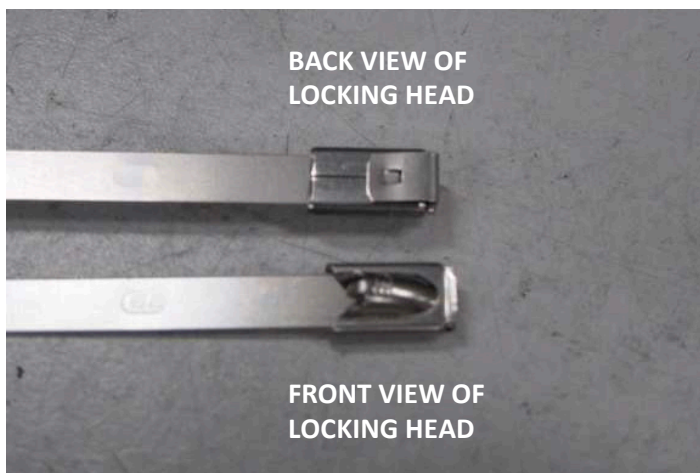

SSTTT2 - RATCHET SET JAW/TOOTH REPLACEMENT

CABAC P/N: Y-SSTTT2 JAW and SSTTT2

1. Do not undo any screws, take a photo.
2. Lay the tool left side down.
3. Using a (approximately) 4 mm pin punch or a suitably sized cross head screwdriver! push /punch out the two 4mm roll pins that can be seen through the two access holes.
4. Pull the trigger and the jaw/tooth and it's carrier can now be removed from the other side of the tool.
5. Take another photo of the carrier so as to remember which way round the little spring and bits go.
6. Push / punch out the carrier pivot pin just far enough to remove the jaw/tooth part.
7. Replace the jaw/tooth part (with the spare that was provided with the tool when purchased)being careful with the orientation of little spring.
8. Push the pivot pin back home.
9. Remount the carrier and drive in the roll pins.

The important bit is not to disassemble the whole tool, as although it is easy to reassemble most people forget how it came apart!!!

