

Heavy duty cable strap and accessories

Strap on reel and reel kits, double locking heads & pre-assembled Deltec® cable ties



Characteristics

- Designed to perform a minimum of 20 years outdoors
- Double locking head with corrosion resistant locking barbs in copper alloy
- No sharp edges: operator friendly, cable friendly!
- Easy to install, low installation costs
- Extremely robust ties, with high tensile strength (1110N) after fastening
- Available either in pre-cut and pre-assembled lengths, or on reels with separate heads for total flexibility
- Choice of specific spacers and accessories
- Month and year of manufacture stamped into strap material

Technical information

- Material - Strap & head: Toughened weatherable acetal
- Material - Locking barb: Marine grade, corrosion-resistant copper alloy
- Temperature range: -65°C to +90°C (-85°F to 194°F)
- Flammability rating: UL 94 HB
- Color: Black
- Other properties: UV-resistant, Halogen free, superior resistance to moisture and salt environments

Strap on reel and reel kits

Product code	GID No.	Length per reel L		Width W		Min. tensile strength [N]	Included heads [pieces]	Reel quantity [pieces]
		[m]	[ft]	[mm]	[in]			
TYD-50R	7TAA159090R0005	15.2	50	12.7	0.5	1110	0	1
696-41794	7TAA159090R0000	304.8	1000	12.7	0.5	1110	0	1
CSS-5K	7TAA159120R0000	15.2	50	-	-	-	150	5
CSS-10K	7TAA159130R0001	15.2	50	-	-	-	300	5

Note: the recommended maximum continuous static loading for the Deltec® straps is 90 N per strap.
For best results, suggested spacing is 35 to 40cm. It is the responsibility of the user to determine if their installation provides sufficient load support.
Reel kits (CSS-5K / CSS-10K) to be assembled with Deltec® strap on reel.

Double locking heads

Product code	GID No.	Length L		Width W		Height		Quantity [pieces]
		[mm]	[in]	[mm]	[in]	[mm]	[in]	
TYD-LH	7TAA159090R0006	21.6	0.9	19.1	0.75	12.6	0.50	25
696-41795	7TAA159090R0001	21.6	0.9	19.1	0.75	12.6	0.50	1000

To be assembled with Deltec® strap on reel

Dimensions

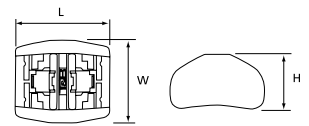

Pre-assembled Deltec® cable ties

Product code	GID No.	Max. bundle dia.		Length L		Width W		Min. tensile strength [N]	Quantity [pieces]
		[mm]	[in]	[mm]	[in]	[mm]	[in]		
CSS-100	7TAA159110R0000	76	3	254	10	12.7	0.5	1112	25
CSS-135	7TAA159090R0003	89	3.5	343	13.5	12.7	0.5	1112	25
CSS-160	7TAA159170R0000	102	4	406	16	12.7	0.5	1112	50
CSS-270	7TAA159080R0000	203	8	686	27	12.7	0.5	1112	10

Tooling



WT3D
For use with 12.7mm (1110N) cable ties.
See page 136.



L-500-EU
For use with 12.7mm (1110N) cable ties.
See page 136.

Dimensions

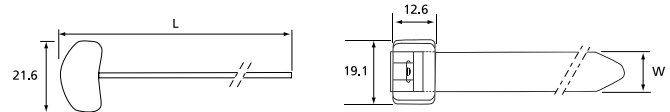

In support of our policy of continuous product improvement we reserve the right to change materials and specifications without notice. Drawings, where used, are not to scale. All dimensions are in millimetres and sizes given are approximate. Where possible, technical MSDS data sheets are made available on the website. All products should be installed and used in accordance with manufacturer's instructions provided. Warning: products may be the subject of registered designs and patents. Refer to website for terms and conditions on warranty.